



- CAT6 RJ45 IN-LINE COUPLER**
- Compliant with EIA/TIA Cat6 Channel Performance specification.
 - Patented PCB (Printed Circuit Board) design for optimal performance.
 - Compact Size: 0.57" x 0.64" x 1.17".



- SHIELDED CAT6 RJ45 IN-LINE COUPLER-PANEL MOUNTABLE**
- Snap-In type enclosure allows easy mounting onto any Keystone Jack wall plates or panels.
 - Fully shielded enclosure meets EMI/RFI requirements.



- CAT6 RJ45 IN-LINE COUPLER PANEL MOUNTABLE**
- Snap-In type enclosure allows easy mounting onto any Keystone Jack wall plates or panels.

ORDER CODE	DESCRIPTION	1-49	50-99	100+
080-RJ45-C6	Cat6 RJ45 In-Line Coupler	\$5.72	5.46	5.07
080-885-SI-C6	Cat6 RJ45 Snap In Type Coupler	5.90	5.63	5.23
080-885-C6-SI-SH	Cat6 RJ45 Snap In Type Coupler, Shielded	6.95	6.64	6.16

** LUCENT NIE EXEMPTION TYPE **

CAT6 CROSS-OVER COUPLER

- RJ-45 Cat6 Cross-Over coupler - meets EIA/TIA 568A Category 6 specification.
- Compact enclosure printed w/wiring scheme - works in any Cat6 Cross-Over coupling environment.
- Patented PCB (Printed Circuit Board) design ensures Cat6 performance.
- Ideal for Hub to Hub cascade, or Station to Station connection of Gigabit Ethernet.
- Wiring Scheme: 1-3, 2-6, 3-1, 4-7, 5-8, 6-2, 7-4, 8-5.

ORDER CODE	1-49	50-99	100+
080-88-CR-C6	\$6.42	6.13	5.69

** LUCENT NIE EXEMPTION TYPE **



KEYSTONE JACK CRIMPING TOOLS

TERMINATION TOOL FOR CAT6 180° TOP-ENTRY MINI KEYSTONE JACK

- Termination and Wire-Cutting Tool for Top-Entry Keystone Jack Module
- Works with Cat6 180° Mini Keystone Jacks (P/N: 07W-188-YY-M)



ORDER CODE	1-9	10-19	20+
061-07W-RD	\$51.95	49.56	46.02

TERMINATION TOOL FOR CAT6 90° RIGHT-ANGLED MINI KEYSTONE JACK

- Termination and Wire-Cutting Tool for Right-Angled Keystone Jack Module
- Works with Cat6 90° Mini Keystone Jacks (P/N: 07WF-188-YY-M)

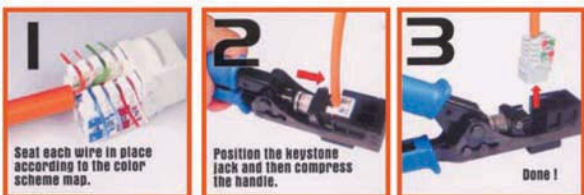

ORDER CODE	1-9	10-19	20+
061-07WF-YL	\$51.92	49.56	46.02

CAT6 110- PUNCH DOWN TYPE IN-LINE COUPLER

- Designed to extend or to fan out CAT6 4-pair cable without RJ45 connections.
- Wiring Scheme: pin to pin, 568A or 568B (258A) standard.
- Internal PCB (Printed Circuit Board) structure with plastic enclosure - meets EIA/TIA Cat6 specifications.
- Color-coded 110 punch down terminals.
- Surface mountable enclosure with cable tie loops.

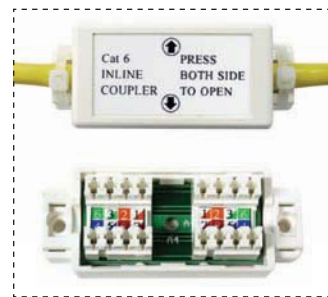

ORDER CODE	1-49	50-99	100+
080-110-4-C6	\$4.84	4.62	4.29



CAT6 110- PUNCH DOWN TYPE IN-LINE SHIELDED COUPLER

- For extension or fan out of shielded CAT6 4-pair cable without RJ-45 connections.
- Shielded enclosure with one dedicated terminal for drain wire punch down.
- Wiring Scheme: Pin to Pin, universal for both 568A or 568B(258A) standard.
- Internal PCB (Printed Circuit Board) structure with chrome plated enclosure - meets EIA/TIA Cat6 specifications.
- Surface mountable enclosure with cable tie loops.
- Color-coded 110 punch down terminals.

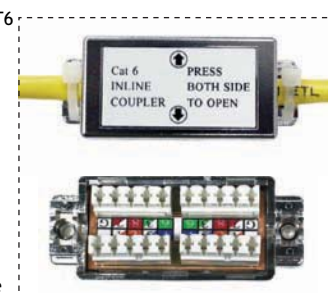

ORDER CODE	1-49	50-99	100+
080-110-4-C6-SH	\$7.39	7.06	6.55

CAT6 SURFACE JACKS



- Compliant with EIA/TIA Cat6 connecting hardware specifications.
- Patented PCB (Printed Circuit Board) design meets Cat6 performance.
- Universal for both 568A and 568B(258A) wiring schemes.

ORDER CODE	DESCRIPTION	1-49	50-99	100+
07Q-S-01-XX	Cat6 Surface Mount Jack, 1 x RJ45	\$6.34	6.05	5.62
07Q-S-02-XX	Cat6 Surface Mount Jack, 2 x RJ45	11.44	10.92	10.14
07Q-S-04-XX	Cat6 Surface Mount Jack, 4 x RJ45	21.12	20.16	18.72

XX = Enclosure Color WH IV

CAT6 PIGTAIL CABLE

CAT6 RJ-45 PLUG TO JACK - 6" PIGTAIL CABLE

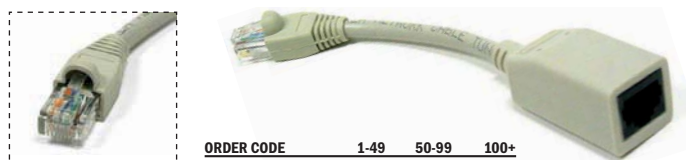

ORDER CODE	1-49	50-99	100+
086-C6-006	\$3.87	3.70	3.43