

**SURFACE MOUNT BOXES**

**SURFACE BOX FOR TOOL-LESS KEYSTONE**

**JACK (07K SERIES)**

ORDER CODE	DESCRIPTION	1-49	50-99	100+
07K-SBX-1-XX	Single Port	\$1.14	1.09	1.01
07K-SBX-2-XX	Dual Ports	1.27	1.21	1.12

XX = Color    WH    IV    BK



**UNIVERSAL SURFACE MOUNTING BOXES**

- Surface mount boxes for 071, 072, 073, 074, and 07M series single and double gang face plates.

ORDER CODE	DESCRIPTION	1-49	50-99	100+
071-BOX-XX	Single Gang	\$2.55	2.44	2.26
071-BOX2-XX	Double Gang	5.19	4.96	4.60

XX = Color    WH    IV



**KEYSTONE JACK SURFACE MOUNT BOXES**

- Compatible with virtually all keystone jacks in the industry (e.g. AMP, TNT, Leviton).
- Recessed designation strips with plastic cover for system or station ID.
- Color plastic icons attachable.
- Double sided tape and mounting hardware included.



(Keystone jack not included)



077-SBX-4-XX-D



077-SBX-6-XX-D

ORDER CODE	DESCRIPTION	1-49	50-99	100+
077-SBX-1-XX	Single Port	\$1.14	1.09	1.01
077-SBX-1-XX-D	Single Port with Dust Cover	1.50	1.43	1.33
077-SBX-2-XX	Dual Ports	1.41	1.34	1.25
077-SBX-2-XX-D	Dual Ports with Dust Cover	2.29	2.18	2.03
077-SBX-4-XX-D	4 Ports with Dust Cover	2.99	2.86	2.65
077-SBX-6-XX-D	6 Ports with Dust Cover	4.66	4.45	4.13

XX = Color    WH    IV

**RAINBOW SERIES : SNAP-IN BEZEL TYPE**

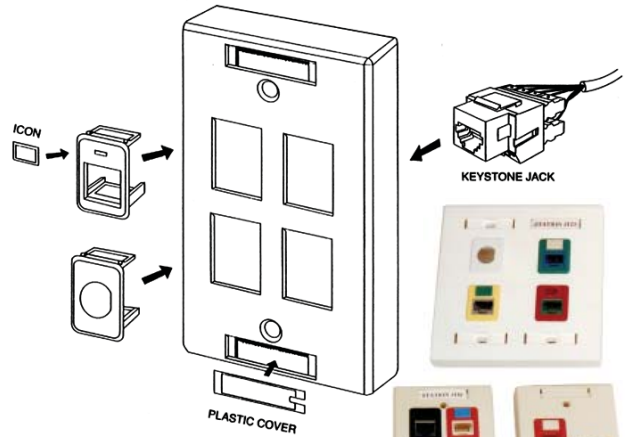

**FLUSH MOUNT SOLUTION**

ORDER CODE	DESCRIPTION	1-49	50-99	100+
073-F01-XX	Single Gang, 1 Cutout	\$1.04	0.99	0.92
073-F02-XX	Single Gang, 2 Cutouts	1.04	0.99	0.92
073-F03-XX	Single Gang, 3 Cutouts	1.04	0.99	0.92
073-F04-XX	Single Gang, 4 Cutouts	1.04	0.99	0.92
073-F06-XX	Single Gang, 6 Cutouts	1.04	0.99	0.92
073-F21-XX	Double Gang, 1 Cutout	1.62	1.55	1.44
073-F22-XX	Double Gang, 2 Cutouts	1.62	1.55	1.44
073-F24-XX	Double Gang, 4 Cutouts	1.62	1.55	1.44
073-F26-XX	Double Gang, 6 Cutouts	1.62	1.55	1.44
073-F28-XX	Double Gang, 8 Cutouts	1.62	1.55	1.44

XX = Color    WH    IV

**45° ENTRY FACE PLATE - ONE, TWO, & FOUR PORTS**

- 45° entry controls the bend radius of mating cable, ensures CAT5E transmission integrity.
- Single gang with up to 4 cutouts.
- Works with snap-in bezel type modules.



ORDER CODE	DESCRIPTION	1-49	50-99	100+
073-F01-XX-A	One Cutout	\$1.04	0.99	0.92
073-F02-XX-A	Two Cutouts	1.04	0.99	0.92
073-F04-XX-A	Four Cutouts	1.04	0.99	0.92

XX = Color    WH    IV

**DECORA SINGLE GANG FACE PLATES**

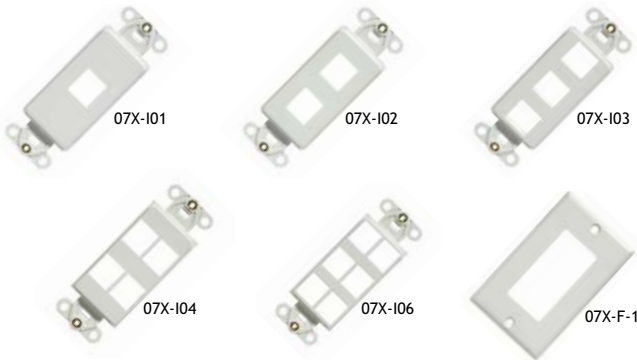

ORDER CODE	DESCRIPTION	1-49	50-99	100+
07X-101-IV	Single Gang Face Plate, 1 Port, Ivory	\$0.69	0.66	0.61
07X-101-WH	Single Gang Face Plate, 1 Port, White	0.69	0.66	0.61
07X-102-IV	Single Gang Face Plate, 2 Ports, Ivory	0.69	0.66	0.61
07X-102-WH	Single Gang Face Plate, 2 Ports, White	0.69	0.66	0.61
07X-103-IV	Single Gang Face Plate, 3 Ports, Ivory	0.69	0.66	0.61
07X-103-WH	Single Gang Face Plate, 3 Ports, White	0.69	0.66	0.61
07X-104-IV	Single Gang Face Plate, 4 Ports, Ivory	0.86	0.82	0.76
07X-104-WH	Single Gang Face Plate, 4 Ports, White	0.86	0.82	0.76
07X-106-IV	Single Gang Face Plate, 6 Ports, Ivory	0.86	0.82	0.76
07X-106-WH	Single Gang Face Plate, 6 Ports, White	0.86	0.82	0.76
07X-F-1-IV	Single Gang Cover Plate, Ivory	0.51	0.49	0.45
07X-F-1-WH	Single Gang Cover Plate, White	0.51	0.49	0.45

**FACE PLATE**

**MODULAR FURNITURE FACE PLATE**

- Accepts all snap-in modules such as CAT6, CAT5E data, Category 3 data and voice grade jack for UTP.
- Hassle-free access - changes can be made without removing the furniture kickplate.
- Fits most modular furniture lines.



ORDER CODE	DESCRIPTION	1-49	50-99	100+
07W-03-WH	3 Port, WHITE	\$0.88	0.84	0.78
07W-03-IV	3 Port, IVORY	0.88	0.84	0.78

**MODULES FOR 073 RAINBOW SERIES SOLUTIONS**



ORDER CODE	DESCRIPTION	1-49	50-99	100+
073-ALL-YY	For all snap-in connectors	\$0.18	0.17	0.16
073-FBK-XX	Blank Insert Module	0.26	0.25	0.23
073-FSM-YY	Keystone Jack Bezel	0.18	0.17	0.16
073-FBN-XX-L	Insert of BNC Bulkhead	2.64	2.52	2.34
073-FCF-XX-L	Insert of F Bulkhead	1.76	1.68	1.56
073-FST-XX-L	Insert of ST Bulkhead	5.98	5.71	5.30
073-ICON-YY	Color Icon (4 sets of 3 icons)	0.26	0.25	0.23
073-ICON-ST	Icon Label Sticker	0.26	0.25	0.23

XX = Color    WH    IV

YY = Color    WH    BK    PP    RD    GY    BL    GN    OR    YL

073-ICON-YY

073-FBK